

# SIEMENS

## SIMATIC

### Industrial PC IPC277E 19" INOX PRO

#### Compact Operating Instructions

---

#### Preface

---

#### Product description

1

---

#### Safety instructions

2

---

#### Installing the device

3

---

#### Maintaining and repairing the device

4

---

#### Specifications

5

---



#### Technical support

A

## Legal information

### Warning notice system

This manual contains notices you have to observe in order to ensure your personal safety, as well as to prevent damage to property. The notices referring to your personal safety are highlighted in the manual by a safety alert symbol, notices referring only to property damage have no safety alert symbol. These notices shown below are graded according to the degree of danger.

 <b>DANGER</b>
indicates that death or severe personal injury <b>will</b> result if proper precautions are not taken.
 <b>WARNING</b>
indicates that death or severe personal injury <b>may</b> result if proper precautions are not taken.
 <b>CAUTION</b>
indicates that minor personal injury can result if proper precautions are not taken.
<b>NOTICE</b>
indicates that property damage can result if proper precautions are not taken.

If more than one degree of danger is present, the warning notice representing the highest degree of danger will be used. A notice warning of injury to persons with a safety alert symbol may also include a warning relating to property damage.

### Qualified Personnel

The product/system described in this documentation may be operated only by **personnel qualified** for the specific task in accordance with the relevant documentation, in particular its warning notices and safety instructions. Qualified personnel are those who, based on their training and experience, are capable of identifying risks and avoiding potential hazards when working with these products/systems.

### Proper use of Siemens products

Note the following:

 <b>WARNING</b>
Siemens products may only be used for the applications described in the catalog and in the relevant technical documentation. If products and components from other manufacturers are used, these must be recommended or approved by Siemens. Proper transport, storage, installation, assembly, commissioning, operation and maintenance are required to ensure that the products operate safely and without any problems. The permissible ambient conditions must be complied with. The information in the relevant documentation must be observed.

### Trademarks

All names identified by ® are registered trademarks of Siemens AG. The remaining trademarks in this publication may be trademarks whose use by third parties for their own purposes could violate the rights of the owner.

### Disclaimer of Liability

We have reviewed the contents of this publication to ensure consistency with the hardware and software described. Since variance cannot be precluded entirely, we cannot guarantee full consistency. However, the information in this publication is reviewed regularly and any necessary corrections are included in subsequent editions.

# Preface

## Validity

This document applies to the following devices with the designation IPC277E 19" INOX PRO, article numbers:

- IPC277E 19" INOX PRO stand variant, article number 6AV7484-5AB00-0AA0
- IPC277E 19" INOX PRO support arm variant, article number 6AV7484-5AB10-0AA0

This document describes the technical differences between the device and the basic device IPC277E 19" Touch with the article number 6AV7882-0EB30-2LA0 that is installed in the IPC277E 19" INOX PRO.

The notes contained in this document take precedence over the information contained in the documentation of the basic device, in the release notes and in the online help.

You can find the documentation of the basic device on the Internet at the following address:  
SIMATIC IPC277E documentation  
(<https://support.industry.siemens.com/cs/ww/en/ps/21356/man>)

## Conventions

The term "device" is also used instead of the product designation in this document.

## Figures

This document contains figures of the device described. The figures can deviate from the particularities of the delivered device.

# Table of contents

	<b>Preface</b> .....	<b>3</b>
<b>1</b>	<b>Product description</b> .....	<b>5</b>
<b>2</b>	<b>Safety instructions</b> .....	<b>9</b>
2.1	General safety instructions .....	9
2.2	Notes on use.....	10
<b>3</b>	<b>Installing the device</b> .....	<b>11</b>
3.1	Permitted mounting positions.....	11
3.2	Mounting and connecting the device.....	11
<b>4</b>	<b>Maintaining and repairing the device</b> .....	<b>17</b>
4.1	Replacing the backup battery .....	17
4.2	Cleaning the device .....	20
4.2.1	Cleaning the Device Front .....	20
4.2.2	Clean screen .....	21
4.2.3	Chemical Resistance.....	22
4.2.4	Working with stainless steel surfaces.....	22
4.3	Repair .....	23
<b>5</b>	<b>Specifications</b> .....	<b>24</b>
5.1	Certificates and approvals .....	24
5.2	Dimension drawings .....	27
5.2.1	IPC277E 19" INOX PRO .....	27
5.2.2	Mechanical interface of the device.....	28
5.3	Technical specifications.....	28
5.3.1	General technical specifications .....	28
5.3.2	Environmental conditions.....	30
5.3.3	Power supply .....	31
5.3.3.1	Power requirements of additional components.....	31
5.3.3.2	Power consumption.....	31
5.3.3.3	DC power supply .....	31
<b>A</b>	<b>Technical support</b> .....	<b>32</b>
A.1	Service and support .....	32

## Product description

The following figures show the front and rear views of the IPC277E 19" INOX PRO.

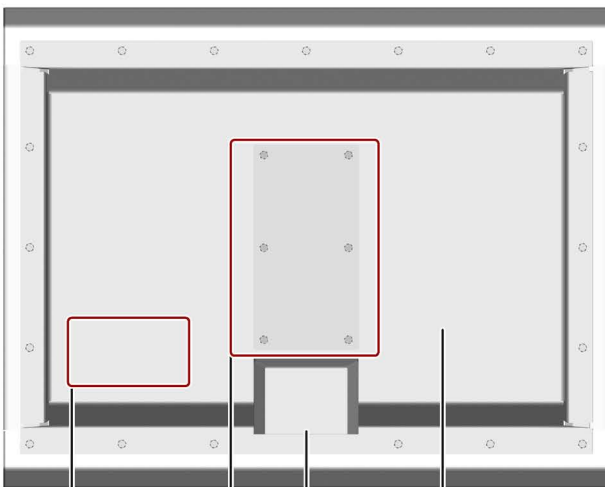

- ① Display with touch screen
- ② Decorative foil
- ③ Position of nameplate and approvals
- ④ Connection compartment
- ⑤ Mechanical interface for fastening
- ⑥ Rear panel

### Features

The housing of the IPC277E 19" INOX PRO contains the standard device SIMATIC IPC277E 19".

In addition, the IPC277E 19" INOX PRO has the following properties:

- Enclosure material: INOX stainless steel, material number 1.4301
- Sealing material: FPM (fluorinated rubber)
- Front membrane: Polyester-based
- Degree of protection: IP66 all-round
- Mechanical interface: For stand mounting or support arm mounting

## Scope of delivery

- 1 x IPC277E 19" INOX PRO
- 1 x 2-pin connecting terminal for the 24 V DC power supply
- 1 x seal for mechanical interface

## Accessories

### Mounting kit for stand mounting

A mounting kit is available for stand mounting of the device. Mounting kit contents:

- 1 stainless steel tube with flange: Length 500 mm, outer diameter 48.3 mm, inner diameter 40 mm.  
The mechanical interface of the stainless steel tube with flange fits the mechanical interface of the device.
- 4 hexagon screws M5×25 made of stainless steel
- 1 flat seal

Article number 6AV7675-1GB00-0AA0

### Mounting kit for support arm mounting

A mounting kit is available for support arm mounting of the device. Mounting kit contents:

- 1 stainless steel tube with flange: Length 500 mm, outer diameter 48.3 mm, inner diameter 40 mm.  
The mechanical interface of the stainless steel tube with flange fits the mechanical interface of the device.
- 1 adapter support arm
- 8 hexagon screws M5×20 made of stainless steel
- 2 flat seals

Article number 6AV7675-1GB10-0AA0

### Service pack

The service pack contains:

- 1 spare seal for the connection compartment cover of the device
- 6 screws for the connection compartment cover of the device
- 1 spare seal for the mechanical interface of the device
- 4 screws for fastening the stainless steel tube with flange from a mounting kit to the mechanical interface of the device
- 1 connecting terminal for the power supply
- 1 terminal block for the terminal strip in the connection compartment
- Documentation

Article number 6AV7675-1JD20-0AA0

**Service pack 2, only in combination with the service manual**

Service pack 2 contains:

- 1 spare seal for the rear panel of the device
- 4 spare screws for the rear panel of the device
- 1 spare seal for the mechanical interface of the device
- 4 screws for fastening the stainless steel tube with flange from a mounting kit to the mechanical interface of the device
- 1 connecting terminal for the power supply
- Documentation

Article number 6AV7675-1JD21-0AA0

**Service pack 3, in connection with devices for support arm mounting**

Service pack 3 contains:

- 1 spare seal for the connection compartment cover of the device
- 1 spare seal for the mechanical interface of the device
- 1 spare seal for support arm mounting
- 8 screws M5 x 20 mm for support arm mounting
- 6 screws for the connection compartment cover of the device
- 1 connecting terminal for the power supply
- 1 terminal block for the terminal strip in the connection compartment
- Documentation

Article number 6AV7675-1JD20-1AA0

## Service manual

A service manual that describes the following maintenance work and more is available for the IPC277E 19" INOX PRO:

- Replacing the seal of the rear panel
- Converting a device for stand mounting into a device for support arm mounting and vice versa



### **WARNING**

**Opening the device and working on the opened device may only be carried out by qualified and correspondingly trained personnel**

The service manual describes, amongst other points, the opening of the device and working on the wiring or on electronic components in the inside of the device. Injuries or material damage may result if the work is not carried out correctly.

The work described in the service manual may only be carried out by qualified specialist personnel who have been trained correspondingly by Siemens.

The service manual is available online under "Product Support" next to this document in the same branch of the product tree.



# Safety instructions

# 2

## 2.1 General safety instructions

 <b>WARNING</b>
<p><b>Performing a function test when installing the device in machines or systems</b></p> <p>Following the results of a risk analysis, additional protection equipment on the machine or the system is necessary to avoid endangering persons. In particular, the programming, parameter assignment and wiring of the inserted I/O must be executed in accordance with the safety performance identified by the necessary risk analysis (SIL, PL or Cat.). The intended use of the device has to be ensured.</p> <p>The proper use of the device has to be verified with a function test on the system. These tests help you to identify programming, parameter assignment and wiring errors. The test results have to be recorded and, if necessary, entered into the safety verification documents.</p>

### Defective touch screen

 <b>WARNING</b>
<p><b>Risk of explosion, personal injury or material damage in the case of a defective touch screen</b></p> <p>The application of excessive force to the device front can destroy the device touch screen, for example, piercing the front membrane or breaking the touch screen carrier plate. There is a risk of explosion, injury and food contamination with additional consequential and health damage.</p> <p>Make sure that excessive force cannot be applied to the device front.</p> <p>If the device touch screen is defective, decommission the affected machine immediately and replace the device at once. When replacing the device, please note the chapter "Repair (Page 23)".</p>

### Battery and rechargeable battery

 <b>WARNING</b>
<b>Risk of explosion and release of harmful substances</b>
Improper handling of lithium batteries can result in an explosion of the batteries.
Explosion of the batteries and the released pollutants can cause severe physical injury. Worn batteries jeopardize the function of the device.
Note the following when handling lithium batteries:
<ul style="list-style-type: none"><li>• Replace used batteries in good time; see the section "Replacing the backup battery" in the operating instructions.</li><li>• Replace the lithium battery only with an identical battery or types recommended by the manufacturer (order no.: A5E34345932).</li><li>• Do not throw lithium batteries into fire, do not solder on the cell body, do not recharge, do not open, do not short-circuit, do not reverse polarity, do not heat above 100°C and protect from direct sunlight, moisture and condensation.</li></ul>

### ESD



Electrostatically sensitive components include almost all electrical, electronic, optoelectronic and electromechanical components. These components are sensitive to overvoltage for technical reasons and their function may be impaired or destroyed by electrostatic discharge. Observe the regulations governing the handling of ESD components.

## 2.2 Notes on use

---

### Note

Avoid direct or indirect contact with food in the area of the device's decorative foil to avoid possible cross contamination.

---

## Installing the device

### 3.1 Permitted mounting positions

The device may only be operated in landscape format with a maximum inclination of  $\pm 30^\circ$  to the vertical.

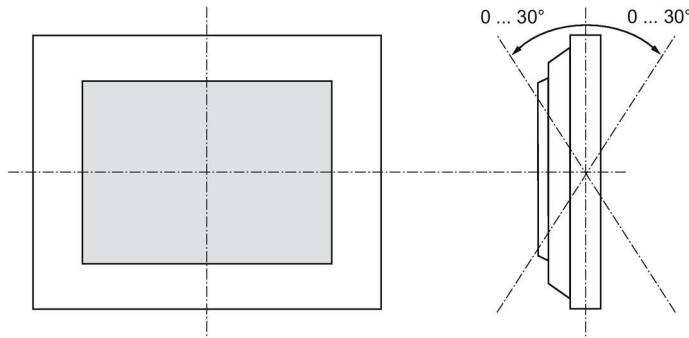

Permissible ambient temperature: 0 ... 45 °C

### 3.2 Mounting and connecting the device

This section describes how to mount and connect the device correctly, using stand mounting as an example. Mounting on a support arm is carried out in the same way. All the work steps in this chapter have to be carried out sequentially for complete mounting of the device.

#### Requirements

- A stand with a mechanical interface suitable for the mechanical interface of the device; see section "Mechanical interface of the device (Page 28)".
- The following lines are routed through the stand:
  - Protective conductor, minimum cross-section of 2.5 mm<sup>2</sup>
  - Lines for the external power supply, voltage-free
  - All required data lines
- Four hexagon screws M5 according to screw standard ISO 4017, material X5CrNi18-10

The length of the screws have to be dimensioned so that the penetration depth of the screw thread in the device-side flange lies in the range of 6 to 10 mm.

### Opening the connection compartment and installing the device

---

#### Note

The device is fastened to a stand or a support arm via the mechanical interface with four screws.

Siemens AG assumes no liability for the consequences of a faulty installation.

---

#### **WARNING**

##### **The device must be mounted securely**

Inadequately dimensioned fastening material may cause the device to fall down. Serious bodily injury may result.

Make sure that fasteners are adequately dimensioned during installation of the device. Make sure to consider the weight of the device and the forces acting on the device when dimensioning the fasteners. This applies in particular to dynamic load of the device.

Observe any further statutory specifications applying at the location of use of the device and further applicable regulations with regard to the fastening of the device.

#### **NOTICE**

##### **Placing the device on its front side**

Place the device on a soft and elevated surface during installation so that the front is not scratched.

### Procedure

1. Open the connection compartment. To do so, remove the 6 screws on the device rear that are marked in the following figure and remove the connection compartment cover and associated seal.

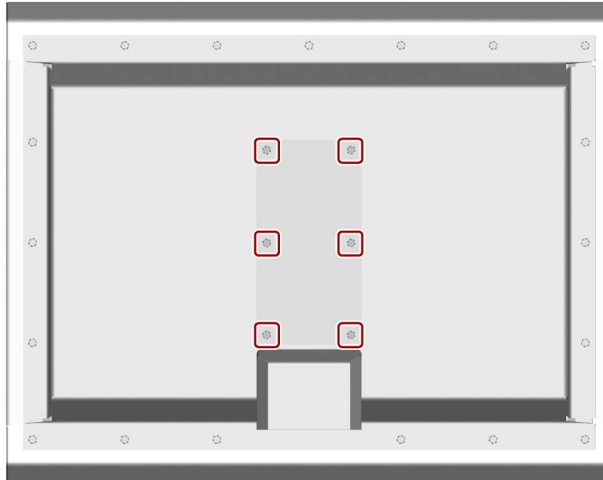

2. Place the supplied seal for the mechanical interface with its smooth side onto the stand. Center the openings of the seal and of the mechanical interface of the stand.
3. Route the lines from the stand through the opening of the mechanical interface of the device into the connection compartment.
4. Place the mechanical interface of the device onto the mechanical interface of the stand. Take the following into account:
  - The seal has to lie exactly in the mechanical interface of the device.
  - The lines must not be squeezed. Hold the lines slightly tensioned while placing the device on the stand.
5. Fasten the device to the mechanical interface of the stand using the four M5 screws. Insert the screws from below through the mechanical interface and tighten the screws with a torque of 3.5 Nm. The degree of protection IP66 is only ensured with this torque. The device is mounted on the stand. The following steps describe the installation in the connection compartment.

6. The following figure shows the position of the interfaces, the on/off switch and the battery box.  
Switch off the device using the on/off switch ⑨.

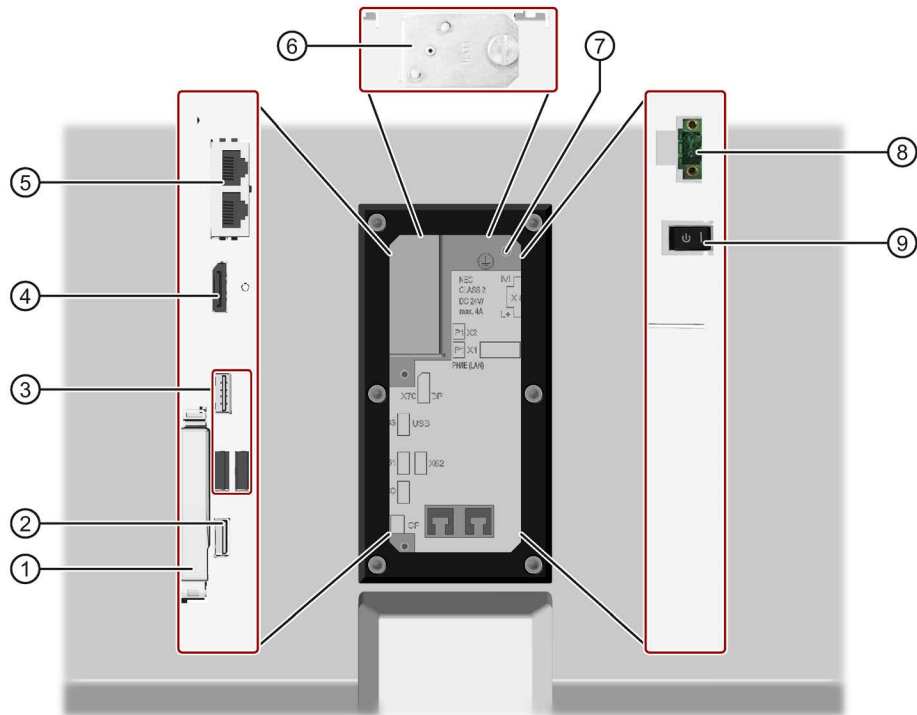

- ① CFast slot
- ② USB 3.0 port, high current
- ③ USB 2.0 ports. A maximum of 2 USB ports may be operated simultaneously in high-current mode.
- ④ DisplayPort connection
- ⑤ Ethernet interfaces LAN1 and LAN2
- ⑥ Battery compartment
- ⑦ Connection for protective conductor
- ⑧ Connection for the 24 V DC power supply
- ⑨ On/off switch

**Note**

The interfaces are rotated by 180° in comparison to the standard device. Correspondingly, the memory card and lines are to be connected or plugged rotated by 180°.

**Connecting the device and closing the connection compartment**

**Important notes on connecting**

The protective conductor connection is needed to protect the device and helps ensure that interference signals generated by power lines, signal lines or lines to I/O devices are safely discharged to earth.

The protective conductor connection on the device must be connected to the protective conductor of the control cabinet or system in which the device is installed.

** WARNING****Electric shock and fire hazard when protective conductor is not connected**

High voltage may be present in a defective device, which can cause fire or an electric shock if touched. Death and serious bodily injury can result.

- Connect the device to the protective conductor before you put it into operation.
- Never operate the device without protective conductor.
- If a device is defective, remove it from operation without delay and label it accordingly.

** WARNING****Risk of fire and electric shock**

The on/off switch does not isolate the device from the power supply. Risk of electric shock if the device is opened incorrectly or defective. There is also a risk of fire if the device or connecting lines are damaged.

You should therefore protect the device as follows:

- Always pull out the power plug when you are not using the device or if the device is defective. The power plug must be freely accessible.
- Connect the device to a protective conductor as instructed (see "Connecting the protective conductor").
- Use a central isolating switch in the case of cabinet installation.

** WARNING****Electric shock and fire hazard with unsuitable power supply**

Voltages that exceed an extra-low voltage can cause electric shock or fire. Death or serious bodily injury can result.

- Always wire the device to a 24 V DC power supply that is compliant with SELV requirements in accordance with IEC/UL/EN/DIN EN 60950-1.
- A current source in accordance with NEC Class 2 is required in order to fulfill the requirements according to UL 60950-1 and UL 508.
- In all other cases according to IEC/EN/DIN EN 60950-1, either a current source of limited output (LPS = Low Power Source), or a line-side fuse or a line-side circuit breaker is necessary. Current must be limited to 4.16 A. This requires a max. 4 A fuse.

**Procedure**

1. Connect the protective conductor to the protective conductor connection ⑦ in accordance with the SIMATIC IPC277E operating instructions. The protective conductor connection is identified by the following symbol:



The minimum cross-section of the protective conductor is 2.5 mm<sup>2</sup>.

The protective conductor connection is needed to protect the device and helps ensure that interference signals generated by power lines, signal lines or lines to I/O devices are safely discharged to earth.

2. Connect the lines for the power supply via the associated connecting terminal to the connection for the power supply ⑧ in accordance with the SIMATIC IPC277E operating instructions.
3. If you use a memory card, insert the memory card.
4. Connect the connectors of the data lines to the corresponding interface.
5. Secure the data lines with cable ties to the fastening elements in the connection compartment that are marked in the following figure.

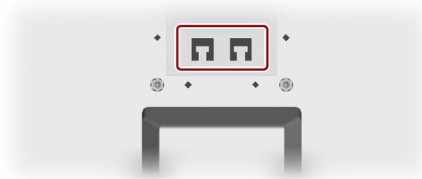

6. Switch the device on using the on/off switch ⑨.
7. Place the seal of the connection compartment cover around the connection compartment. Ensure that the latches of the seal lie in the associated notches and that the seal lies flush on the device rear panel.
8. Fasten the connection compartment cover with 6 screws. Tighten the screws using a torque of 3.5 Nm.



## Maintaining and repairing the device

### 4.1 Replacing the backup battery

#### Prior to replacement

 <b>WARNING</b>
<b>Risk of explosion and release of harmful substances</b> Improper handling of lithium batteries can result in an explosion of the batteries. Explosion of the batteries and the released pollutants can cause severe physical injury. Worn batteries jeopardize the function of the device. Note the following when handling lithium batteries: <ul style="list-style-type: none"><li>• Replace the battery every 5 years.</li><li>• Replace the lithium battery only with an identical battery or types recommended by the manufacturer. The order number is A5E34345932.</li><li>• Do not throw lithium batteries into fire, do not solder on the cell body, do not recharge, do not open, do not short-circuit, do not reverse polarity, do not heat above 100°C and protect from direct sunlight, moisture and condensation.</li></ul>

<b>NOTICE</b>
<b>Disposal of batteries and rechargeable batteries</b> Do not dispose of used batteries and rechargeables in household waste. Users are obliged by law to return used batteries and rechargeable batteries. Used batteries and rechargeable batteries pollute the environment as hazardous waste. Improper disposal of used batteries and rechargeables renders you liable to prosecution. When disposing of rechargeable batteries, observe the following: <ul style="list-style-type: none"><li>• Dispose of used batteries and rechargeable batteries separately as hazardous waste in accordance with local regulations.</li><li>• You can return used batteries and rechargeables to public collection points and wherever batteries and rechargeable batteries of the type in question are sold.</li><li>• Label the battery container with "Used batteries and rechargeable batteries".</li></ul>

4.1 Replacing the backup battery

Requirement

- The device is disconnected from the power supply.
- The connection compartment is open.

Removing the battery

**NOTICE**

**Time may be deleted**

The time will be deleted if it takes you longer than 30 seconds to replace the battery. The device is no longer synchronous. Time-controlled programs will no longer run or will run at the wrong time. This may damage the plant.

Reset the time for the device.

1. Loosen the screw for the battery box.
2. Open the battery box.
3. Remove the battery, with the Velcro fastener, from the battery box.
4. Unplug the battery from the device power supply cable.

Dispose of the used batteries in accordance with the notes "Disposal of batteries and rechargeable batteries" at the beginning of this section.

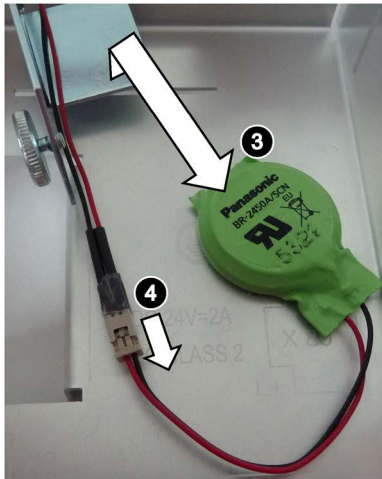
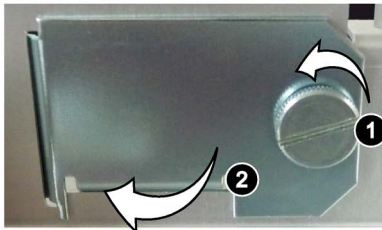

## Installing the battery

To install the replacement battery, follow the steps for removing the battery in the reverse order. Velcro fasteners are provided with the replacement battery.

1. Connect the plug of the replacement battery with the device power supply cable. Make sure that the plug clicks into the socket.
2. Stick a Velcro fastener on the bottom of the battery and attach the battery to the fastener in the battery box as shown. Make sure the battery is correctly positioned.
3. Close the battery compartment and screw the battery box closed again.

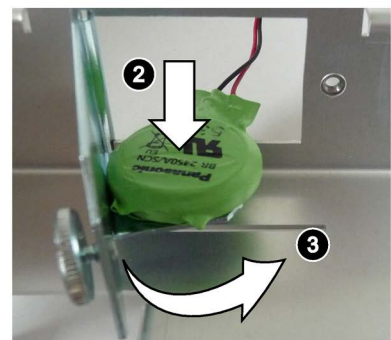
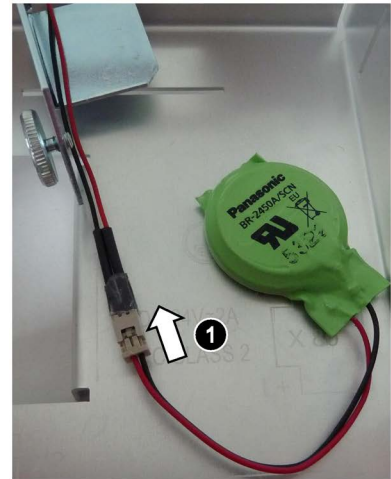

## 4.2 Cleaning the device

### 4.2.1 Cleaning the Device Front

The device is designed for low-maintenance operation. You should still clean the device front regularly, however.

 **CAUTION**

**Unwanted reactions when cleaning the device**

You risk unintentional actuation of operator controls if you clean the device while it is switched on.

You may possibly trigger unwanted actions of the device or controller that are liable to cause personal injury or damage to the machinery.

Always switch off the device before you clean it.

### Cleaning Agents

**NOTICE**

**Damage to the device due to impermissible cleaning agents**

Impermissible and unsuitable cleaning agents may cause damage to the HMI device.

Use dish soap or foaming screen cleaner only as cleaning agents.

Do not use aggressive solvents or scouring powder.

### Cleaning the Device Front

1. Switch off the device.
2. Dampen the cleaning cloth.
3. Spray the cleaning agent on the cloth and not directly on the device.
4. Clean the device with the cleaning cloth.

**Note**

**Cleaning methods**

In addition to the specifications in this section, the following applies for cleaning the device:

**Permitted:** Cleaning with strong jet water under increased pressure in accordance with DIN EN 60529:2014-09, specifications on "IP66".

**Not permitted:**

- Do not clean the HMI device using aggressive cleaners or detergents, greasing or abrasive detergents, acids or caustic solutions, leather, scratching or rough rags and equipment.  
For further information, refer to the section "Chemical resistance".
  - Do not clean the HMI device with chlorine or chloride, for example, active chlorine, laser or ultrasonic equipment or dry ice.
  - You damage the operating front if you clean the HMI device with high pressure equipment. Do not disinfect the device thermally, for example, using hot steam equipment, because this would damage the operating front, particularly the touch sensor system.
- 

## 4.2.2

### Clean screen

If you use the WinCC RT Advanced software in connection with the device, you can clean the touch screen of the device while it is switched on and the project running. An operating element must be available in the project that can be used to call the "clean" screen. Once the clean screen is activated, touch screen operation is locked for a configured period of time. The time the touch screen is locked can be set between 5 and 30 seconds. The time remaining for the lockout is indicated by a progress bar.

---

**Note**

**Unintentional responses**

When cleaning the touch screen, an unintentional response in the controller can be triggered by touching keys.

Always open the clean screen or switch off the device before you clean the touch screen while the system is running.

**Cannot be operated when the clean screen is active**

When the clean screen is active, operations on the device are not possible.

Wait for the period of the clean screen to lapse. Then you can operate the system again with the device.

---

### 4.2.3 Chemical Resistance

#### Front membrane

The resistance of the front membrane to various chemicals has been tested to DIN 42 115, section 2. The front membrane is resistant to the chemicals listed below:

- Alcohol
- Diluted acids
- Diluted caustic solutions
- Ester
- Hydrocarbons
- Household cleaners

You can find information of chemical resistance on the Internet (<http://support.automation.siemens.com/WW/view/en/39718396>).

#### Seals

The seals made of FPM (fluorinated rubber) are approved for food according to FDA regulations.

### 4.2.4 Working with stainless steel surfaces

#### Resistance

Information on the resistance of stainless steel:

- The stainless steel surface is not fully resistant against the chemicals listed below:
  - Hydrochloric acid
  - Sulphuric acid
  - Sodium hydroxide
  - Chlorine
  - Chlorides

Do not clean the stainless steel surface with these chemicals or with similar acids or caustic solutions.

- Acid steam develops, for example, when tiles are cleaned with hydrochloric acid, and is also harmful to the stainless steel. If the stainless steel parts are unintentionally contaminated with hydrochloric acid, rinse these off immediately with plenty of water.
- Clean the stainless steel surface with a cleansing agent without active chlorine.

## Cleaning guidelines

Further information on stainless steel surfaces:

- The surface should be properly ventilated.
- Keep the surface clean. Remove cleaners and food residue immediately. Always avoid the return of food stuff splashes to the production process.
- If mechanical cleaning is necessary, do not use cleaning equipment made of metal.
  - Use brushes made of plastic or natural materials, or a microfiber pad.
  - Use plenty of water to clean the surface.
  - Make sure that the cleansing agent is completely removed without any residue.
- Make sure surface is not damaged: Do not damage the device during operation, or by cleaning or repairing it using hard tools, in particular tools made of corrodible materials.
- Make sure that the surface does not come into contact with rusted parts.

This includes water pipes, filings, residue from wire brushes or steel wool. These, as well as rust films have a corrosive effect on parts made of stainless steel.

- Remove any stains or rust immediately.
- Remove new rust spots with a mild abrasive detergent in order to prevent any further corrosion.
- Rinse the part thoroughly after you cleaned it.

## 4.3 Repair

In case of repair, the device must be shipped to the Return Center in Erlangen. Repairs may only be carried out at the Return Center in Erlangen.

The device described in this document is covered by the conditions of repair and return of equipment, as follows:

1. You return the defective device to the returned goods center. The address is:

Siemens AG  
Digital Factory Retouren-Center  
c/o Geis Service GmbH, Tor 1-4  
Kraftwerkstraße 25a  
91056 Erlangen  
Germany

2. After it has been repaired, the device is returned to you. A new device will not be supplied in exchange.

Depending on the work necessary to repair the device, the Center may decide to give you a credit note. In this case, it is your responsibility to order a new device.

For additional information, refer to the Internet at Spare parts and repairs (<http://support.automation.siemens.com/WW/view/en/16611927>).

# Specifications

## 5.1 Certificates and approvals

---

**Note**

This section lists the certificates and approvals possible for the device.

Only those approvals specified on the rear of your device apply to your device.

---

A copy of the certificates can be requested from the following address:

Siemens AG  
Digital Factory  
Factory Automation  
DF FA SE R&D  
Breslauer Str. 5  
DE-90766 Fürth

### DIN ISO 9001 certificate

The quality assurance system for the entire product process (development, production, and marketing) at Siemens fulfills the requirements of ISO 9001.

This has been certified by DQS (the German society for the certification of quality management systems).

### Software license agreements

If the device is supplied with preinstalled software, you must observe the corresponding license agreements.



**cULus approval**

Underwriters Laboratories Inc., to

- UL 508 (Industrial Control Equipment)
- CSA C22.2 No. 142 (Process Control Equipment)

**or cULus approval, Hazardous Location**

cULus Listed INT. CONT. EQ. FOR HAZ. LOC.

Underwriters Laboratories Inc., to

- UL 508 (Industrial Control Equipment)
- CSA C22.2 No. 142 (Process Control Equipment)
- ISA 12.12.01 (Hazardous Location)
- CSA-213 (Hazardous Location) APPROVED for Use in
- Cl. 1, Div. 2, GP. A, B, C, D T4A
- Cl. 1, Zone 2, GP. IIC T4

**FM Approval**

Factory Mutual Research (FM) conforming to

- Approval Standards FM 3611, FM 3600, FM 3800, ANSI/ISA 61010-1

Approved for use in

- Class I, Division 2, Group A, B, C, D T4
- Class I, Zone 2, Group IIC T4

**ATEX/IECEx approval**



**Special conditions of use**

The SIMATIC Industrial PC with article number 6AV7484-5AB..-0AA0 including the top side of the stand provides a degree of protection of at least IP66. The bottom side of the stand shall be connected to a certified enclosure, providing a degree of protection of at least IP54 according to IEC 60079-15 for gas and non-conductive dust and IP6X according to IEC 60079-31, for conductive dust, taking into account the environmental conditions under which the equipment is used.

The equipment shall be installed in such a way that the risk of mechanical danger is low.

To avoid an electrostatic charge, wipe the enclosure surface with a damp cloth only.

When used in an area requiring the use of equipment with EPL Gc:

- The equipment shall only be used in an area of not more than pollution degree 2, as defined in EN 60664-1.
- Provisions shall be made to prevent the rated voltage from being exceeded by transient disturbances of more than 119 V.

Under the special conditions mentioned, the following approvals apply to the device:

- II 3 G Ex nA IIC T4 Gc and  
II 3 D Ex tc IIIC T70 °C Dc

ATEX certificate number: DEKRA 16ATEX0045X

Standards: EN 60079-0:2012 +A11:2013, EN 60079-15:2010, EN 6007931:2014

- Ex nA IIC T4 Gc and  
Ex tc IIIC T70 °C Dc

IECEx certificate number: DEK 16.0021X

Standards: IEC 60079-0:2011 (Ed.6), +Corr.1. 2012 +Corr.2. 2013, IEC 60079-15:2010 (Ed. 4), IEC 60079-31:2013 (Ed. 2)

**Notes on CE marking**



This product meets the requirements and safety objectives of the EMC directive 2014/30/EU "Electromagnetic Compatibility", and is designed for operation in the following fields of application according to this CE marking:

Field of application	Requirement for emissions	Requirement for interference immunity
Industrial area	EN 61000-6-4:2007 +A1:2011	EN 61000-6-2:2005

## 5.2 Dimension drawings

### 5.2.1 IPC277E 19" INOX PRO

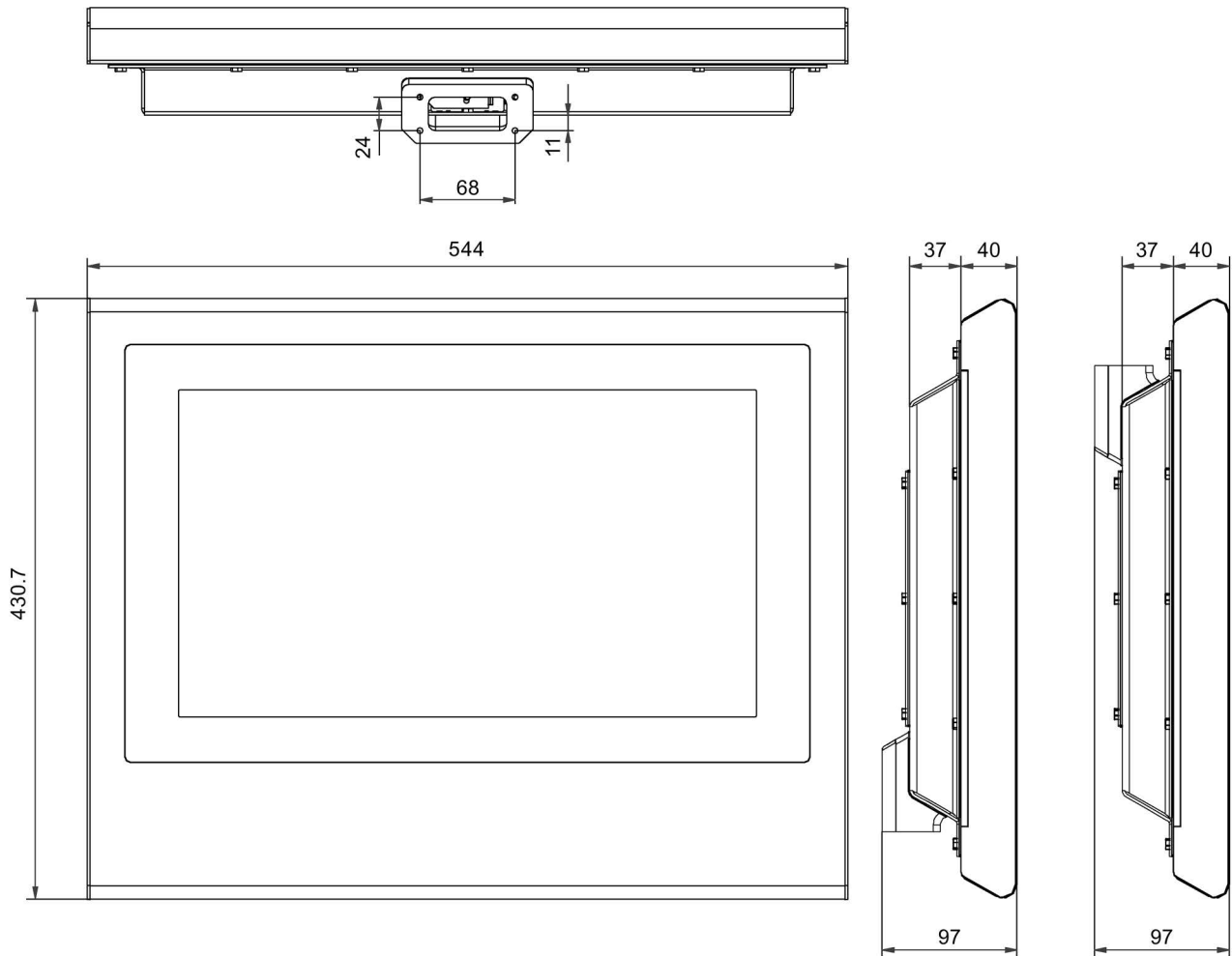

All dimensions in mm.

### 5.2.2 Mechanical interface of the device

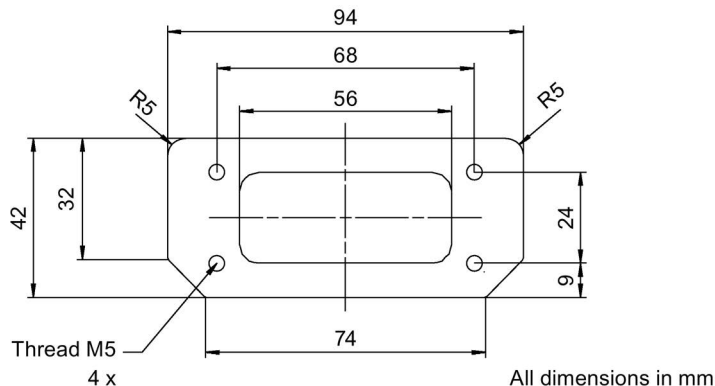

## 5.3 Technical specifications

### 5.3.1 General technical specifications

Weight	Approx. 15 kg
Power supply <sup>1</sup>	24V DC (19.2 to 28.8 V)
Short-term voltage interruption in accordance with Namur	Min. 20 ms (DC), max. 10 events per hour; min. 1 s recovery time
Rated power consumption (DC):	Constant current, typical: 2 A Continuous current, maximum: 4 A
Degree of protection	IP66 all-round <sup>2</sup> according to DIN EN 60529:2014-09
Quality assurance	In accordance with ISO 9001

<sup>1</sup> The generation of the supply voltage with the line-side power supply must be realized as safety extra-low voltage with safe electrical isolation, isolated as SELV according to IEC/UL/EN/DIN-EN 60950-1 and LPS/NEC Class 2.

<sup>2</sup> When all the covers are closed and all the connecting lines have been connected properly with the device

## Electromagnetic compatibility

Emission standard	EN 61000-6-4; CISPR 22:2010 Class A; FCC Class A
Immunity with regard to conducted interference on the supply lines	± 2 kV in accordance with IEC 61000-4-4; burst ± 1 kV in accordance with IEC 61000-4-5; symmetrical surge ± 2 kV in accordance with IEC 61000-4-5; asymmetrical surge
Noise immunity on signal lines	± 2 kV in accordance with IEC 61000-4-4; burst; length > 3 m ± 2 kV in accordance with IEC 61000-4-5; symmetrical surge, length > 30 m
Immunity to electrostatic discharge	± 6 kV contact discharge in accordance with IEC 61000-4-2 ± 8 kV air discharge in accordance with IEC 61000-4-2
Immunity to RF interference	10 V/m, 80 to 2000 MHz 80% AM according to IEC 61000-4-3 3 V/m, 2 to 2.7 GHz 10 V, 9 kHz to 80 MHz according to IEC 61000-4-6
Immunity to magnetic fields	100 A/m, 50/60 Hz according to IEC 61000-4-8

## Main circuit board

Processor	Intel Celeron N2930, 1.83 GHz
Main memory	DDR3, 8 GB, memory cannot be exchanged.
Backup memory	512 KB MRAM, of which 128 KB can be backed up at full load in the buffer time of the power supply

## Drive, memory medium

CFast memory card	<ul style="list-style-type: none"> <li>• 4 GB or</li> <li>• 8 GB or</li> <li>• 16 GB</li> </ul>
Floppy and CD-ROM drive	External, can be connected via USB port <sup>1</sup>
USB stick	External, can be connected via USB port

<sup>1</sup> Only to USB port of the device, not via USB hub

## Graphics

Display, resolution	19" diagonal with backlighting, resolution 1366 x 768 pixels
Touch controller	Resistive Semtech controller ELO CTR-2216SU-AT-CHP-00 Touch screen analog resistive Touch force with test pen; 2 mm diameter: 5 N
Backlighting (MTBF) Half brightness life time, typical	LED min. 50000 h at 50 °C, 50% brightness
Pixel error class in accordance with ISO 9241-307	II

**Interfaces**

DisplayPort (DPP)	Connection of display devices with DPP connection
USB	4 USB ports, maximum 6 W USB load. <ul style="list-style-type: none"> <li>• 3 × USB 2.0, a maximum of 2 can be operated in high-current mode at the same time</li> <li>• 1 x USB 3.0, high current</li> </ul>
LAN ports X1 P1/X2 P1, RJ45 <sup>1</sup>	Intel LAN-Controller Springville i210; 10, 100, 1000 Mbps, teaming is supported <sup>2</sup>
Keyboard, mouse	Connection via USB port

- <sup>1</sup> For unique labeling, the LAN interfaces are numbered on the enclosure. The numbering by the operating system can differ.
- <sup>2</sup> Teaming can be set and initiated in the configuration interface. In teaming operation, jumbo frames, e.g. for the camera application, are not supported.

**5.3.2 Environmental conditions**

**Climatic ambient conditions**

Temperature, tested in accordance with IEC 60068-2-1, IEC 60068-2-2	
• Temperature gradient in operation	Max. 10 °C/h, no condensation
• Ambient temperature in operation	0 ... 45 °C
• Temperature during storage/transport	-20 to +60 °C
• Storage/transport, gradient	Max. 20 °C/h, no condensation
Relative humidity, tested in accordance with IEC 60068-2-78, IEC 60068-2-30	
• Operation	5 ... 85% at 30 °C, no condensation
• Storage/transport	5 to 95% at 25/55 °C, no condensation
Air pressure, in accordance with IEC 60068-2-13	
• Operation	1080 to 795 hPa, corresponds to an elevation of -1000 to 2000 m
• Storage/transport	1080 to 660 hPa, corresponds to an elevation of -1000 to 3500 m

**Mechanical ambient conditions**

Vibration, tested according to IEC 60068-2-6	
• Operation	10 to 58 Hz: 0.15 mm 58 to 500 Hz: 10 m/s <sup>2</sup> , 10 cycles
• Storage/transport	5 to 8.5 Hz: 7 mm 8.5 to 500 Hz: 10 m/s <sup>2</sup>
Shock resistance, tested in accordance with IEC 60068-2-27, IEC 60068-2-29	
• Operation	150 m/s <sup>2</sup> , 11 ms, 100 shocks per axis
• Storage/transport	250 m/s <sup>2</sup> , 6 ms, 1000 shocks per axis

### 5.3.3 Power supply

#### 5.3.3.1 Power requirements of additional components

##### Maximum permitted current consumption at the USB ports

Auxiliary components		Maximum permitted power consumption, voltage +5 V	Max. total power
USB device 3.0	High current	900 mA	6 W (for all USB devices)
	Low current	100 mA	
USB Device 2.0	High current	500 mA	

#### 5.3.3.2 Power consumption

Device	Typical power consumption (at a rated voltage of 24 V)
Basic device with Intel Celeron N2930	36 W
Maximum USB extension	Max. 6 W

#### 5.3.3.3 DC power supply

Input voltage	24 VDC (19.2 to 28.8 VDC)
Power consumption <sup>1</sup>	Max. 72 W
Power failure buffering	Hold-up time > 15 ms (after > 5 ms, DC_FAIL becomes active)
Maximum continuous output power <sup>1</sup>	60 W

<sup>1</sup> The performance specifications apply to the power supply component, but not to the device.

#### Note

##### Inrush current

The device needs an inrush current of at least 4.5 A for 25 ms.

The peak value of the inrush current depends on the input voltage and the impedance of the 24 V source; peak currents in excess of 4.5 A are possible. This will not have a negative impact on device functionality.

# Technical support

## A.1 Service and support

You can find additional information and support for the products described on the Internet at the following addresses:

- Technical support (<https://support.industry.siemens.com>)
- Support request form (<http://www.siemens.com/automation/support-request>)
- After Sales Information System SIMATIC IPC/PG (<http://www.siemens.com/asis>)
- SIMATIC Documentation Collection (<http://www.siemens.com/simatic-tech-doku-portal>)
- Your local representative  
(<http://www.automation.siemens.com/mcms/aspa-db/en/Pages/default.aspx>)
- Training center (<http://sitrain.automation.siemens.com/sitrainworld/?AppLang=en>)
- Industry Mall (<https://mall.industry.siemens.com>)

When contacting your local representative or Technical Support, please have the following information at hand:

- MLFB of the device
- BIOS version for industrial PC or image version of the device
- Other installed hardware
- Other installed software

## Tools & downloads

Please check regularly if updates and hotfixes are available for download to your device. The download area is available on the Internet at the following link:

After Sales Information System SIMATIC IPC/PG (<http://www.siemens.com/asis>)